

Hall Probes Standard Programme

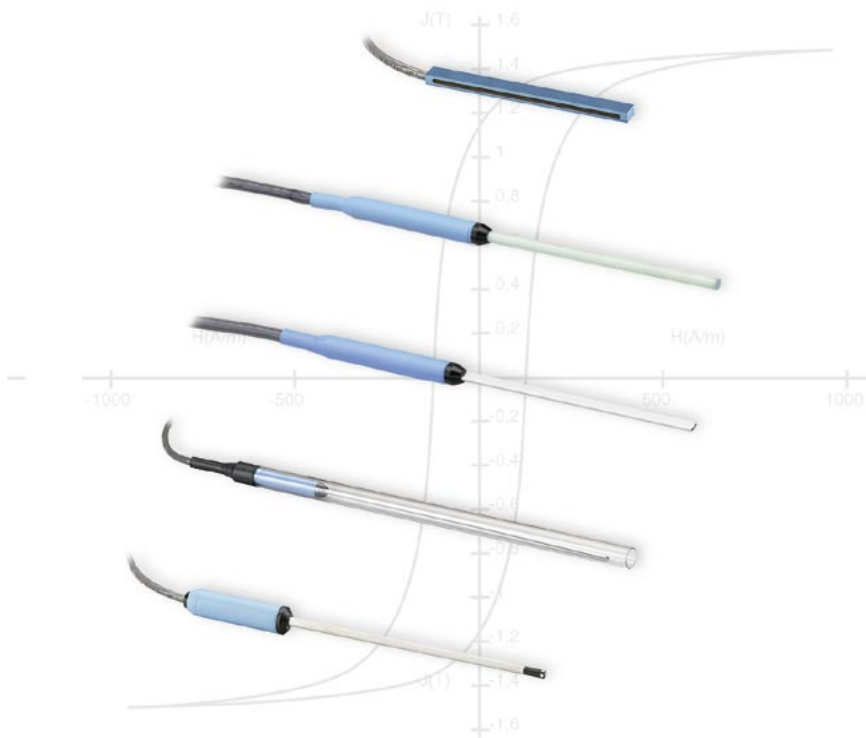

- More than 500 different probes for every application
- For magnetic fields up to 30 Tesla
- For air gaps > 0.5 mm
- Customer-specific solutions for special applications
- All probes with test certificate

Features

- Hall probes for use with Gaussmeters
- Comprehensive probe programme for all measuring requirements
- EEPROM probe connector
- Automatic selection and entry of probe data into the measuring instrument

Axial probes

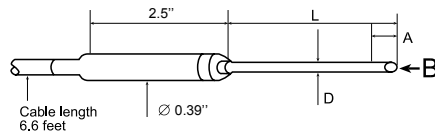

| Model | L | D | A | Stem Material | Corrected accuracy (%) of reading | Temperature coefficient (maximum) zero | Temperature coefficient (maximum) calibration |
|-------------|-------------|-----------------|--------|------------------|-----------------------------------|--|---|
| MMA-2502-VH | 2" ± 0.063" | 0.25" ± 0.006" | 0.015" | Aluminum | ± 0.25 % to 30 kG | ± 0.09 G/°C | - 0.04 %/°C |
| MNA-1904-VH | 4" ± 0.125" | 0.187" ± 0.005" | 0.005" | Fiberglass epoxy | | | |
| MMA-2502-VG | 2" ± 0.063" | 0.25" ± 0.006" | 0.015" | Aluminum | ± 0.15 % to 30 kG | ± 0.13 G/°C | - 0.005 %/°C |
| MNA-1904-VG | 4" ± 0.125" | 0.187" ± 0.005" | 0.005" | Fiberglass epoxy | | | |

Transverse probes

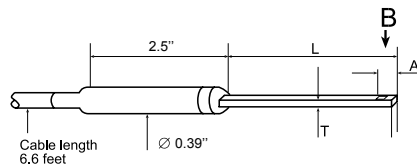

| Model | L | D | A | Stem Material | Frequency Range | Corrected accuracy (%) of reading | Temperature coefficient (maximum) zero | Temperature coefficient (maximum) calibration |
|-------------|-------------|------------|--------|-------------------|------------------------|-----------------------------------|--|---|
| MMT-6J04-VH | 4" ± 0.125" | 0.061" max | 0.180" | Aluminum | DC | ± 0.25 % to 30 kG | ± 0.09 G/°C | - 0.04 %/°C |
| MNT-4E04-VH | | 0.045" max | 0.150" | Rigid glass epoxy | DC and 10 Hz to 400 Hz | | | |
| MMT-6J04-VG | | 0.061" max | 0.180" | Aluminum | DC | ± 0.15 % to 30 kG | ± 0.13 G/°C | - 0.005 %/°C |
| MNT-4E04-VG | | 0.045" max | 0.150" | Rigid glass epoxy | DC and 10 Hz to 400 Hz | | | |

Flexible transverse probes

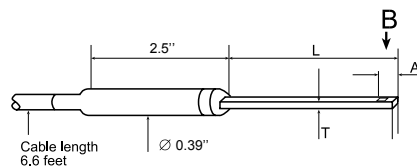

| Model | W | T | Active Area | Stem Material | Frequency Range | Corrected accuracy (%) of reading | Temperature coefficient (maximum) zero | Temperature coefficient (maximum) calibration |
|-------------|------------|------------|---------------------|-----------------|------------------------|-----------------------------------|--|---|
| MFT-3E03-VH | 0.135" max | 0.025" max | 0.040" dia (approx) | Flexible Tubing | DC and 10 Hz to 400 Hz | ± 0.25 % to 30 kG | ± 0.09 G/°C | - 0.04 %/°C |
| MFT-3E03-VG | | | | | | ± 0.15 % to 30 kG | | |

2-axis probes 3-axis probes

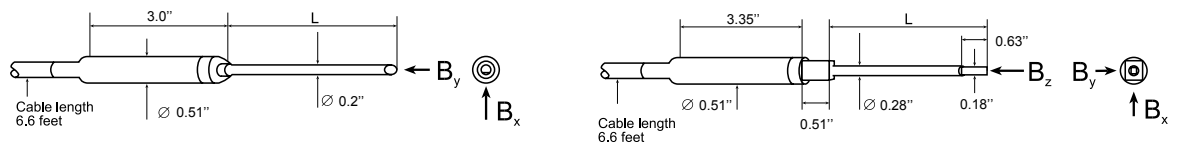

| Model | L | Stem Material | Frequency Range | Usable full scale ranges | Corrected accuracy (%) of reading | Operating temperature range | Temperature coefficient (maximum) zero | Temperature coefficient (maximum) calibration |
|-------------|-------------|---------------|------------------------|----------------------------|-----------------------------------|-----------------------------|--|---|
| MMY-1808-UH | 8" ± 0.125" | Aluminum | DC and 10 Hz to 400 Hz | 30 G, 300 G 3 kG, 30 kG | 0.25 % to 20 kG | 10°C to 40°C | ± 0.09 G / °C | ± 0.015 % / °C |
| MMY-1818-UH | 18" ± 0.25" | | | | 0.5 % from 20 to 30 kG | | | |

L = length D = diameter A = area



Hystograph

AC/DC system

Fluxmeter

Gaussmeter

Other measuring systems:

- Hystograph
- AC/DC Hystograph
- Fluxmeter

Other products:

- Measuring Technology for Soft Magnetic Materials
- Magnetizing Technology
- Internet Marketplace for Used Instruments
- Services

BROCKHAUS MESSTECHNIK
Advanced Measuring Technologies

Dr. Brockhaus Messtechnik GmbH & Co. KG
Gustav-Adolf-Str. 4 · D-58507 Lüdenscheid
P.O. Box 13 27 · D-58463 Lüdenscheid
+49 (0) 700 brockhaus
+49 (0) 2351 3644-0
+49 (0) 2351 3644-44 fax
www.brockhaus.net · mail@brockhaus.net